

# Installation Instructions

CATALOG #: 700116 / 700116B  
2016+ Camaro Eliminator Axle Back

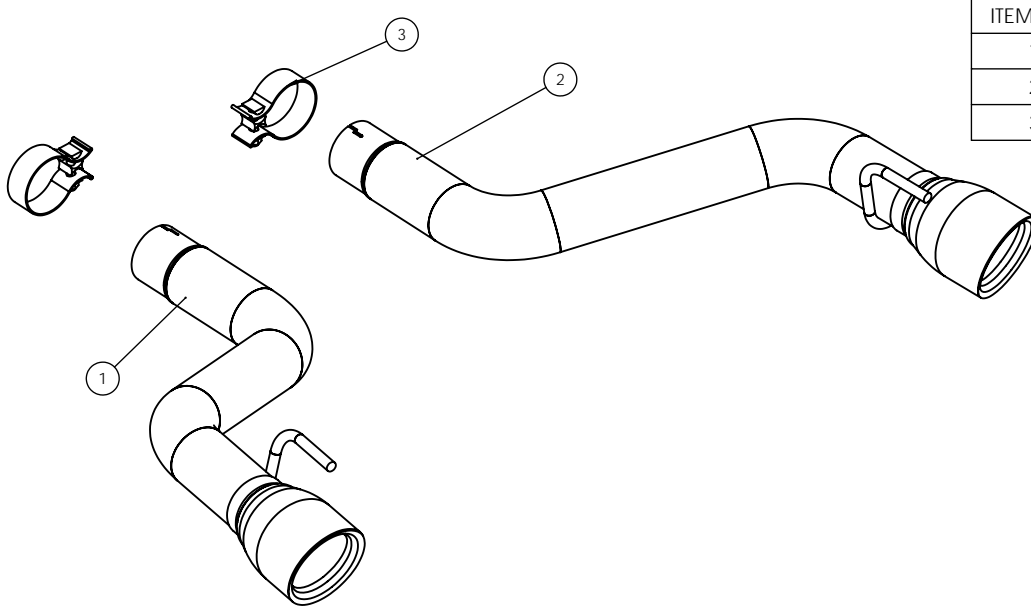

**Caution! Never work on a hot exhaust system. Burns or other serious injuries can result. Always allow the exhaust system to cool before removal. Always consult vehicle manual for proper lifting and support guidelines. Always wear approved safety glasses when working. Serious injury or death can result if safety precautions are not followed.**



| ITEM NO. | DESCRIPTION               | QTY. |
|----------|---------------------------|------|
| 1        | LEFT ELIMINATOR ASSEMBLY  | 1    |
| 2        | RIGHT SIDE ELIMINATOR     | 1    |
| 3        | 2.75 TORCA ACCUSEAL CLAMP | 2    |

## Removal of factory exhaust

Image A.

- Mark both sides of the factory exhaust even with the rear edge of the rear crossmember.
- Using a sawzall cut both sides of the factory exhaust even with the rear crossmember as shown in image A.
- Remove all burrs from the cut area using a file.
- Unbolt the rear exhaust hangers from the vehicle and remove the factory muffler assembly
- Spray the factory exhaust hangers with spray lubricant and remove from factory muffler, these hangers will be on your new exhaust. Note that the hanger brackets must be reinstalled on the same side and direction from which they were removed.

## Installing new exhaust

- Slide a 2.75 accuseal clamp over the factory exhaust.
- Place a tip assembly onto the factory exhaust and slide the hanger into the factory rubber isolator. Use spray lubricant on the hanger to make it easier to install
- Align and position the exhaust tips. starting from the front, tighten all clamps.

**Note:** After initial startup a small trace of smoke may be visible from the exhaust, do not be concerned. This is from residual oils left in the tube from the manufacturing process and will dissipate quickly.

Quick Time Performance recommends professional installation on all of our products.

Made in the USA