

**Installation Instructions**  
**PART# 600110 / 600110B**  
**2010 - 2013 Camaro SS 6.2L**  
**AR3 Axle Back**

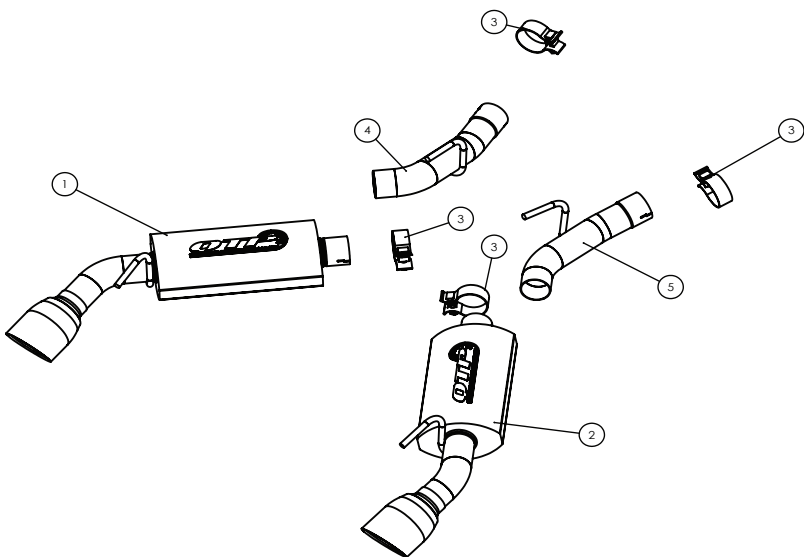

Made in the USA

**Caution! Never work on a hot exhaust system. Burns or other serious injuries can result. Always allow the exhaust system to cool before removal. Always consult vehicle manual for proper lifting and support guidelines. Always wear approved safety glasses when working. Serious injury or death can result if safety precautions are not followed.**



ITEM NO.	DESCRIPTION	QTY.
1	LEFT MUFFLER ASSEMBLY	1
2	RIGHT MUFFLER ASSEMBLY	1
3	2.5 TORCA ACCUSEAL CLAMP	4
4	LEFT STUB PIPE ASSEMBLY	1
5	RIGHT STUB PIPE ASSEMBLY	1

**Removal of Factory Equipment:**

- Step 1:** Raise and support Vehicle. Using a sawzall, cut the factory exhaust even to the diff housing flange (Figures 1,2.) Square the cut to the tube centerline
- Step 2:** Spray the rear factory hangers with spray lubricant.
- Step 3:** Carefully remove each muffler buy removing the hangers from the rubber isolators. Once removed deburr the cut end of the remaining factory exhaust with a file. It is critical to remove all burrs as they may keep the new pipes from slipping over the factory exhaust.



Use seam between diff cover and diff housing as a cut line  
 Figure 1

**Installation of New Exhaust**

- Step 4:** Slide a 2.5" Torca accuseal clamp onto the end of each stub pipe
- Step 5:** Slide the expanded end of the stub pipe over the factory exhaust. Spray some lubricant onto the hanger rod and slip it into the factory rubber isolators. Repeat for other side
- Step 6:** Slide the accuseal clamps into position, center the exhaust tip in the rear valence opening and snug exhaust clamps. Check final position and torque exhaust clamps to 35 ft-lbs. Tighten the muffler clamps first, then the stub pipe clamps. Note: it may be necessary to readjust the exhaust and retighten the clamps after the initial 20 mile drive cycle.
- Step 7:** Slide a 2.5 Torca accuseal clamp onto the end of each muffler assembly
- Step 8:** Slide the expanded end of the muffler assembly onto the stub pipe. Spray some lubricant onto the hanger rod and slip it into the factory rubber isolators. Repeat other side.

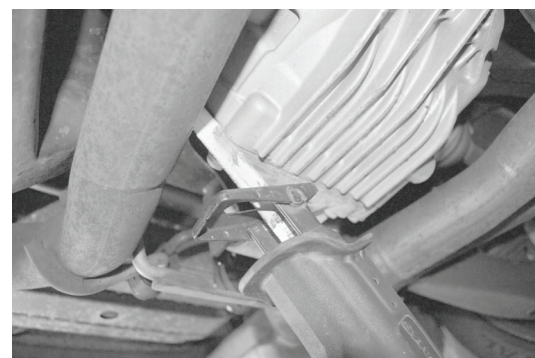

Figure 2

**Note: After initial startup a small trace of smoke may be visible from the exhaust, do not be concerned. This is from residual oils left in the tube from the manufacturing process and will disipate quickly. Check & re-torque all clamps after 50 miles of your new install.**

Quick Time Performance recommends professional installation on all of our products.

## **Notice of Disclaimer and Liability**

The Federal Government, each of the fifty states, local municipalities, towns and counties regulate emissions production, noise levels and safety standards. Quick Time Performance Inc make no warranties of merchantability, of fitness for a particular purpose, or that its products are approved for general use, or that its products comply with laws, regulations or ordinances in the states where they may be sold to the ultimate purchaser, the consumer. Unless stated otherwise on our website, instruction sheet or price list, all risk to the conformity of any of the products offered by Quick Time Performance. Inc. or its affiliates in any such state and as to repair should the product prove defective or non-conforming, is on the retail purchaser, the buyer, the ultimate consumer of such product and it is not upon the seller, distributor or manufacturer. In this connection, the retail purchaser, the buyer, the ultimate consumer assumes the burden of the entire cost of any and all necessary service, alterations or repair. The foregoing statement LIMITS THE LIABILITY OF QUICK TIME PERFORMANCE.COM INC. AND ITS AFFILIATES. QUICK TIME PERFORMANCE, INC. AND ITS AFFILIATES ASKS THAT YOU REMEMBER THAT RACING VEHICLES NEVER BE DRIVEN ON A HIGHWAY OR STREETS ANY WHERE IN THE UNITED STATES. It is illegal to remove or render inoperative any emission control device on any vehicle. Our products are intended for racing vehicles, which have never been intended to be driven on any highway or any street in the United States. In California Vehicle code sections 27156 and 38391 prohibit the advertising, offering for sale, or installation of any device, which modifies a vehicles emission control system unless exempted. Quick Time Performance.Com Inc. and its affiliates have not received an exemption from these code sections and are not legal for sale or use in California on vehicles originally equipped with a catalytic converter. Our products are for racing vehicles, which are never intended for highway or street use. Our products are subject to price change without notice. We reserve the right to reject and cancel any order.

## **Warranty**

Quick Time Performance Inc. provides a limited warranty against defects in materials and workmanship for a period of 90 days from date of sale to the original purchaser. Upon inspection and verification of warranty, Quick Time Performance will, at its option, repair or replace products, which prove to be defective.

## **Exclusions & Limitations**

- Any product, which has been subjected to abuse, accident, alteration, neglected maintenance or improper installation, renders the product warranty null and void.
- Conditions resulting from acts of nature, weather, criminal activity or accidents are subject to adjustment under the product warranty.
- Shipping and handling charges are the responsibility of the end user and are not covered by warranty.
- Any and all labor charges that may be incurred for the removal and or replacement of any covered component or the purpose of affecting this warranty are the sole responsibility of the consumer.
- Leakage

## **Return Policy**

Quick Time Performance Inc. will not accept shipments without prior authorization. In the event it is necessary to return an unused product within 30 days, a return of goods authorization must be obtained from Quick Time Performance Inc. A letter of explanation should be included in the package as well as an invoice or receipt.

## **Questions**

Quick Time Performance Technical Team is available Monday through Friday (9am-4pm eastern time) at (864) 913-1999 or via email at: [sales@quicktimeperformance.com](mailto:sales@quicktimeperformance.com)